



## Chatsworth Gardens, London

At approximately 2350 square foot, this imposing semi-detached home with two storey garden studio is in a sought-after residential pocket of West Acton has been refurbished and maintained to a beautiful standard.

Six bedrooms and four bathrooms ensures plenty of space for a growing family or even multi-generational living, and there is plentiful room for entertaining and family life with a large double reception room on entry at approx. 27 feet in length and a large kitchen-diner to the rear with a hand built bespoke kitchen. All the main rooms have an integrated sound system. The house has a high pressure softened water system for luxurious showers and baths.

- Beautiful period home
- Six bedrooms
- Tastefully refurbished by current owners
- Close to transport links
- Gym/Cinema outbuilding
- Off-street parking

£1,295,000

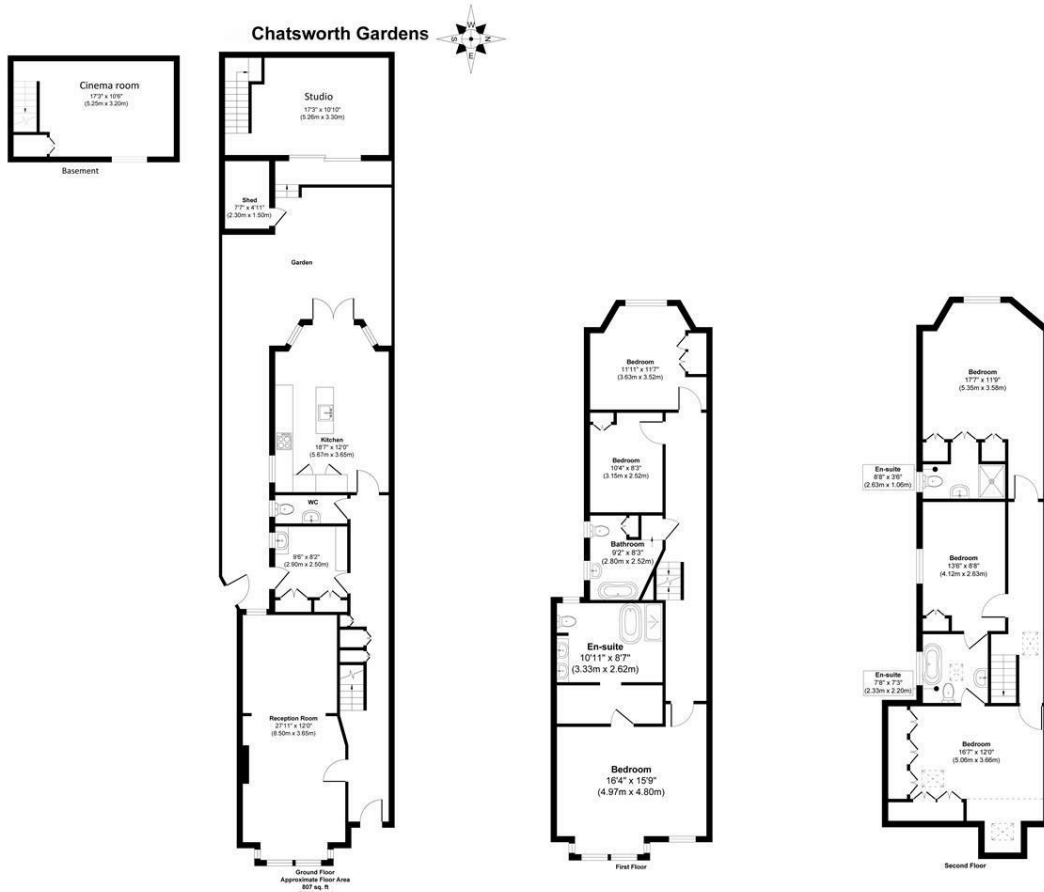

Approx. Gross Internal Floor Area 2354 sq. ft / 218.86 sq. m  
Studio/ Cinema 367 Sq ft / 34.1 Sq M

Illustration for identification purposes only, measurements are approximate, not to scale.  
Produced by Elements Property

Energy Efficiency Rating		Current	Potential
Very energy efficient - lower running costs			
(92 plus) <b>A</b>			
(81-91) <b>B</b>			
(69-80) <b>C</b>			
(55-68) <b>D</b>			
(39-54) <b>E</b>			
(21-38) <b>F</b>			
(1-20) <b>G</b>			
Not energy efficient - higher running costs			
<b>England &amp; Wales</b>		EU Directive 2002/91/EC	